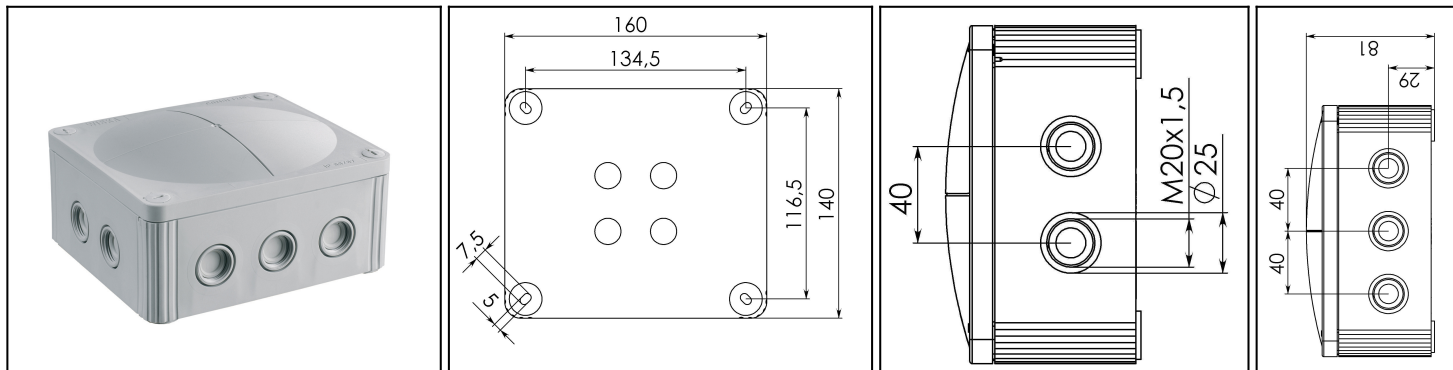

**COMBI 1210**

**Protection class to EN 60 529:**

IP 66/67

**Flame protection:**

Glow wire test 750 C acc. to EN 60695-2-11

**Temperatures during installation:**

-5°C to 60°C

**Temperature range of material:**

-30°C to 100°C, intermittent up to approx. 120°C

**Voltage:**

690 V

**Material:**

Polypropylene, reinforced; Sealing: thermoplastic elastomere

**Terminals/poles:**

 10 mm<sup>2</sup>
**Fixing:**

4 internal openings outside of the sealing area

**Equipment:**

- 10 M 20 inputs with elastic soft membrane and thread, and M 25 breakout opening
- 4 inputs with self-sealing ground membrane
- 4 captive quick-release lid screws
- Colour RAL 7035 light grey
- .../S = black
- .../W = white

Type

 L x B x H  
external/außen  
mm

COMBI 1210

2

3 - 12



160 x 140 x 81